

- 1. Steam compartment Sink
- 2. Food Prep sink
- 3. Steamer
- 4. Kettle
- 5. Braising Pan

↑↑ H.I.D. DOOR
 ↑↑ NON-H.I.D. DOOR

Client Sample Results

Client: Union County Public Schools
Project/Site: Lead in Drinking Water - New Salem

Job ID: 680-197656-1

Client Sample ID: New Salem 3 Comp. Sink

Lab Sample ID: 680-197656-1

Date Collected: 04/05/21 08:03

Matrix: Water

Date Received: 04/14/21 12:30

Method: 200.8-1994 R5.4 - Metals (ICP/MS)

Analyte	Result	Qualifier	RL	MDL	Unit	D	Prepared	Analyzed	Dil Fac
Lead	0.40		0.30	0.060	ug/L		04/16/21 10:03	04/16/21 18:33	1

5

Client Sample ID: New Salem Food Prep Sink

Lab Sample ID: 680-197656-2

Date Collected: 04/05/21 08:00

Matrix: Water

Date Received: 04/14/21 12:30

Method: 200.8-1994 R5.4 - Metals (ICP/MS)

Analyte	Result	Qualifier	RL	MDL	Unit	D	Prepared	Analyzed	Dil Fac
Lead	0.18	J	0.30	0.060	ug/L		04/16/21 10:09	04/16/21 17:19	1

Client Sample ID: New Salem Steamer

Lab Sample ID: 680-197656-3

Date Collected: 04/05/21 08:05

Matrix: Water

Date Received: 04/14/21 12:30

Method: 200.8-1994 R5.4 - Metals (ICP/MS)

Analyte	Result	Qualifier	RL	MDL	Unit	D	Prepared	Analyzed	Dil Fac
Lead	1.6		0.30	0.060	ug/L		04/16/21 10:03	04/16/21 17:53	1

Client Sample ID: New Salem Kettle

Lab Sample ID: 680-197656-4

Date Collected: 04/05/21 08:07

Matrix: Water

Date Received: 04/14/21 12:30

Method: 200.8-1994 R5.4 - Metals (ICP/MS)

Analyte	Result	Qualifier	RL	MDL	Unit	D	Prepared	Analyzed	Dil Fac
Lead	0.80		0.30	0.060	ug/L		04/16/21 10:03	04/16/21 18:02	1

Client Sample ID: New Salem Braising Pan

Lab Sample ID: 680-197656-5

Date Collected: 04/05/21 08:09

Matrix: Water

Date Received: 04/14/21 12:30

Method: 200.8-1994 R5.4 - Metals (ICP/MS)

Analyte	Result	Qualifier	RL	MDL	Unit	D	Prepared	Analyzed	Dil Fac
Lead	0.27	J	0.30	0.060	ug/L		04/16/21 10:03	04/16/21 18:11	1

Client Sample Results

Client: Union County Public Schools
Project/Site: Lead in Drinking Water - New Salem

Job ID: 680-190807-1

Client Sample ID: New Salem 1

Lab Sample ID: 680-190807-1

Date Collected: 10/03/20 12:35

Matrix: Water

Date Received: 10/30/20 13:30

Method: 200.8-1994 R5.4 - Metals (ICP/MS)

Analyte	Result	Qualifier	RL	MDL	Unit	D	Prepared	Analyzed	Dil Fac
Lead	0.39		0.30	0.060	ug/L		11/02/20 13:54	11/02/20 18:42	1

Client Sample ID: New Salem 2

Lab Sample ID: 680-190807-2

Date Collected: 10/03/20 12:41

Matrix: Water

Date Received: 10/30/20 13:30

Method: 200.8-1994 R5.4 - Metals (ICP/MS)

Analyte	Result	Qualifier	RL	MDL	Unit	D	Prepared	Analyzed	Dil Fac
Lead	0.19	J	0.30	0.060	ug/L		11/02/20 13:44	11/02/20 16:27	1



2

Client Sample Results

Client: Union County Public Schools
Project/Site: Lead in Drinking Water - New Salem

Job ID: 680-191950-2

Client Sample ID: New Salem 3

Lab Sample ID: 680-191950-2

Date Collected: 11/21/20 08:06

Matrix: Water

Date Received: 11/24/20 13:40

Method: 200.8-1994 R5.4 - Metals (ICP/MS)

Analyte	Result	Qualifier	RL	MDL	Unit	D	Prepared	Analyzed	Dil Fac
Lead	0.42		0.30	0.060	ug/L		11/25/20 12:59	11/28/20 00:23	1

Client Sample ID: New Salem 4

Lab Sample ID: 680-191950-3

Date Collected: 11/21/20 08:11

Matrix: Water

Date Received: 11/24/20 13:40

Method: 200.8-1994 R5.4 - Metals (ICP/MS)

Analyte	Result	Qualifier	RL	MDL	Unit	D	Prepared	Analyzed	Dil Fac
Lead	0.56		0.30	0.060	ug/L		11/25/20 12:57	11/28/20 08:11	1



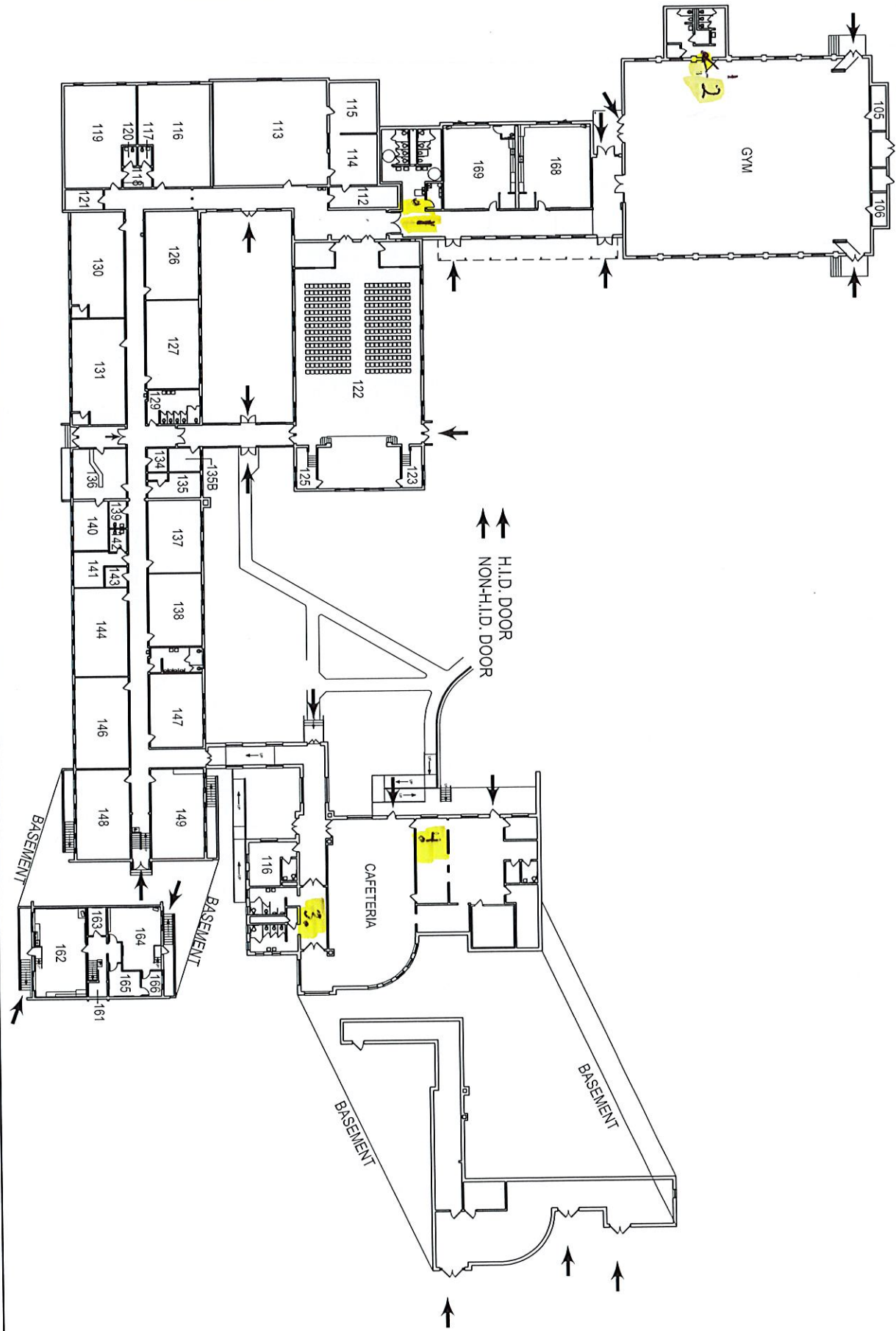

FLOOR	DATE: 11/14/2014
	SCALE: NOT TO SCALE
	REVISIONS:
	PROJECT DESCRIPTION: PROPERTY ACCOUNTING SITE SURVEY

FLOOR PLANS

NEW SALEM
ELEMENTARY SCHOOL
6106 HWY 205
MARSHVILLE, NC 28103

UCPS
UNION COUNTY PUBLIC SCHOOLS
Globalization. Innovation. Graduation.